

MJ-2-PG

Jolly直型PG制接头

Jolly fitting straight, PG



N° 1231385



D.A.T. N° CA02.01256



File: ELE308410CS

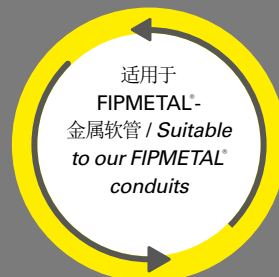
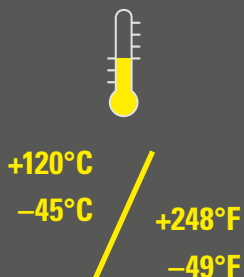

材料: 镀镍黄铜

“Jolly”-接头系统可以通过将其卡在管子本体上安全快速的使用一个螺纹连接器连接在一起，通过旋转的方式连接到管子合适的位置并实现密封。还可以单独连接不同的螺纹型号来匹配对手接头的螺纹型号。“Jolly”-接头系统可以达到IP67密封等级。系统中的密封压缩环可以适用多种多样的 FIPMETAL®金属软管。

Material: Brass nickel plated

The well-respected “Jolly”-Fitting system can be safely and easily assembled with an individual thread adaptor by snapping it onto the conduit fitting body. This is sealed and at the same time swiveled connected to the conduit fitting part. It can be combined individually to provide the required thread type and size for the application of the fitting. The assembled “Jolly”-Fitting can achieve an ingress protection of up to IP67. The included sealing-compression ring allows an universal application of various FIPMETAL® conduits.

MJ-2-PG

产品性能 / Product performances

应用性能 / <i>Application performances</i>	特性 <i>Characteristics</i>	单位 <i>Unit</i>	规范标准 <i>Standards, specifications</i>	备注 <i>Remark</i>
温度范围 <i>Temperature range</i>	-45 到 / <i>to</i> +120 -49 到 / <i>to</i> +248	°C °F	IEC EN 61386	
温度 (短周期) <i>Temperature (short-term)</i>	140 284	°C °F	IS	
机械性能 / <i>Mechanical performances</i>				
IP 防护等级 <i>IP Protection range</i>	可达IP67 <i>up to IP67</i>		EN 60529	
拔脱强度 <i>Pull-out strength</i>	高 <i>high</i>		IS	
抗震动强度 <i>Vibration strenght</i>	非常好 <i>very good</i>		IS	
防火性能 / <i>Fire safety performances</i>				
产品防火特性 <i>Fire characteristic of the product</i>	不易燃 <i>not flammable</i>			
耐候性 / <i>Weathering performances</i>				
抗腐蚀性 <i>Resistant to corrosion</i>	符合 <i>compliant</i>		ISO 9227	

测试条件参照EN ISO 139温度23°C, 湿度 / 50% (如未注明测试条件)。IS FIP= FIP内部测试规范
 Tests carried out acc. EN ISO 139 at 23°C / 50% r. h. (if not indicated different). IS FIP= Internal Specification FIP

产品号 Part No.		螺纹类型 Thread type	适配管子尺寸NW Fits to conduit NW	尺寸 (mm) Dimensions in mm (nom.)			螺纹长度 Thread length	包装单元 PU
FIP	EURO 2000	PG	NW	D	C	C1	mm	个 / Pcs
MJ-210.28331	Jolly 210.28331	PG07	10,0	22,0	20,0	20,0	9,0	10
MJ-210.28332	Jolly 210.28332	PG09	10,0	22,0	20,0	20,0	9,0	10
MJ-210.28333	Jolly 210.28333	PG11	10,0	22,0	20,0	20,0	9,0	10
MJ-210.28334	Jolly 210.28334	PG13,5	10,0	22,0	20,0	20,0	9,0	10
MJ-210.28335	Jolly 210.28335	PG16	10,0	22,0	20,0	24,0	9,0	10
MJ-212.28337	Jolly 212.28337	PG09	12,0	26,0	24,0	24,0	9,0	10
MJ-212.28338	Jolly 212.28338	PG11	12,0	26,0	24,0	24,0	9,0	10
MJ-212.28339	Jolly 212.28339	PG13,5	12,0	26,0	24,0	24,0	9,0	10
MJ-212.28340	Jolly 212.28340	PG16	12,0	26,0	24,0	27,0	9,0	10
MJ-216.28342	Jolly 216.28342	PG11	15,5	29,0	27,0	27,0	9,0	8
MJ-216.28343	Jolly 216.28343	PG13,5	15,5	29,0	27,0	27,0	9,0	8
MJ-216.28344	Jolly 216.28344	PG16	15,5	29,0	27,0	27,0	9,0	8
MJ-216.28345	Jolly 216.28345	PG21	15,5	29,0	27,0	33,0	9,0	8
MJ-221.28347	Jolly 221.28347	PG21	20,5	35,0	33,0	33,0	9,0	8
MJ-221.28348	Jolly 221.28348	PG29	20,5	35,0	33,0	43,0	9,0	8
MJ-227.28351	Jolly 227.28351	PG29	26,5	45,0	43,0	43,0	11,0	4
MJ-227.28352	Jolly 227.28352	PG36	26,5	45,0	43,0	52,0	11,0	4
MJ-235.28354	Jolly 235.28354	PG36	34,5	54,0	52,0	52,0	11,0	4
MJ-235.28355	Jolly 235.28355	PG42	34,5	54,0	52,0	60,0	11,0	4
MJ-240.28357	Jolly 240.28357	PG36	39,5	62,0	60,0	60,0	11,0	2
MJ-240.28358	Jolly 240.28358	PG42	39,5	62,0	60,0	60,0	11,0	2
MJ-240.28359	Jolly 240.28359	PG48	39,5	62,0	60,0	60,0	11,0	2
MJ-250.28361	Jolly 250.28361	PG48	50,5	77,0	74,0	74,0	11,0	2

关于产品库存, 交期, 尺寸及颜色等问题请联系我们本地的经销商或客服。

Please contact our local distribution partner or our customer service regarding product availability, lead time, other sizes and colours.

安装说明 / Assembling instruction:

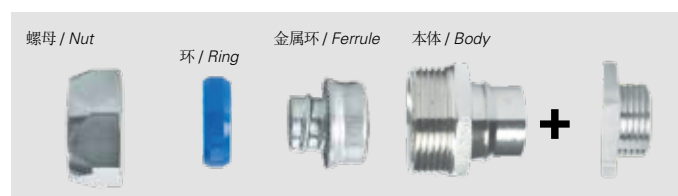

产品代码 / Number code:

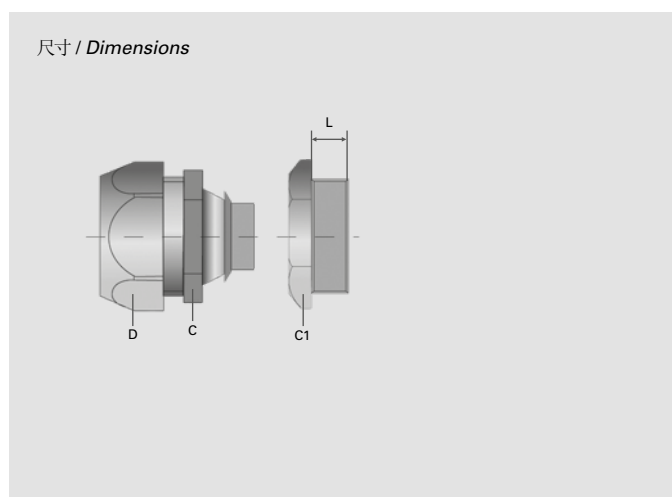
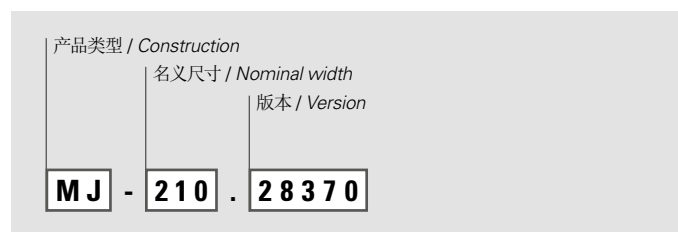

我们尽我们的知识水平所提供的数据, 图像和技术规格图反映了当前的工程技术水平。这包含对最后应用有关的任何责任。产品用户需根据应用进行自己的评估, 以确定产品是否符合特殊的应用条件。我们对产品的责任只考虑一般规定条件下的水平。FIP保留对产品数据和数值进行技术调整的权力。例如更改材料和加工工艺, 在保证产品性能数值不下降的情况下不会另行通知。

The provided data, images and technical specification drawings reflect the current engineering level and are to the best of our knowledge. This does not include any liability regarding the final application. Users of the products have to make their own evaluation to determine the suitability for a specific application. Our liability for these products considers the stated level within our General Conditions only. FRAENKISCHE Industrial Pipes (FIP) reserves the right to adjust specified data and values as well as implementing technical adjustments of the products e. g. change of materials and processing technologies without prior notice as long as the specified values are not reduced.