

COPA-S

固定座
Mounting clip



+120°C
-50°C / +248°F
-58°F

	min.				max.
温度范围 Temperature range	█	█	█	█	█
UV保护性能 UV protection	█	█	█	█	█
低温性能 Cold environment performance	█	█	█	█	█
机械强度 Mechanical strength	█	█	█	█	█

材料: PA6 MOD V0 SGA

FIPLOCK® COPA-S 是一种单层波纹管的固定夹座。由特殊改性的不含卤素的PA6材料制成。单个固定孔的设计简化了安装过程。固定座顶部合理设计有一盖子，极大增强了波纹管与固定座配合后的拔脱力。另外，固定座可与FIPLOCK系列波纹管细波型和粗波型都能够完美适配。

Material: PA6 MOD V0 SGA

The FIPLOCK® COPA-S clip is a one-piece corrugated conduit mounting clip made of specially modified, free-halogen PA6. The single-hole fixation simplifies installation. The resealable cover connected to the clip provides high pull-out forces as well as reliable installation with FIPLOCK® corrugated conduits in fine and coarse profile.

COPA-S

产品性能 / Product performances

应用性能 / Application performances	特性 Characteristics	单位 Unit	标准规范 Standards, specifications	备注 Remark
温度范围 Temperature range	-50 到 / to +120 -58 到 / to +248	°C °F	IS FIP	
温度 (短周期) Temperatur (short-term)	150 (500 h); 165 (100 h) 302 (500 h); 329 (100 h)	°C °F	IS FIP	
防火性能 / Fire safety performances				
不含卤素和镉 Free from halogens and cadmium	是 / yes			
阻燃等级 Fire classification	V0		UL 94	
产品防火特性 Fire characteristic of the product	自熄 self-extinguishing		UL 1696	
氧指数 Oxygen index	>32	%	EN ISO 4589-2	
灼热丝测试 Glow wire test	960 1760	°C °F	IEC 60695	
火灾危害等级 Fire hazardous level	HL3 R22 HL3 R23		EN45545-2	
火焰蔓延 Spread of fire	非火焰蔓延 non flame propagating		IEC EN 61386	
耐候性 / Weathering performances				
UV及耐候性 UV and weathering performance	非常好 very good		IS FIP	15 到 20 年 15 to 20 years

测试条件参照EN ISO 139温度23°C, 湿度 /50% (如未注明测试条件)。IS FIP=FIP内部测试规范。

Tests carried out acc. EN ISO 139 at 23°C/50% r. h. (if not indicated different). IS FIP = Internal Specification FIP

产品号 Part No.		名义尺寸 Nominal width	波型 Profile	尺寸 (mm) Dimensions in mm (nom.)						重量 Weight	包装单元 PU
黑色 / black	灰色 / grey	NW		A	B	H	K	W	M	g	个 / Pcs
COPA-S-07B	COPA-S-07G	07	F	19,5	20,0	22,0	14,0	45,3	4	3,6	10
COPA-S-10B	COPA-S-10G	10	F	22,0	20,0	25,0	16,0	50,3	5	4,2	10
COPA-S-12B	COPA-S-12G	12	F	26,0	20,0	27,0	16,5	58,3	5	5,0	10
COPA-S-17B	COPA-S-17G	17	F/C	33,0	20,0	34,0	20,0	72,3	6	6,9	10
COPA-S-23B	COPA-S-23G	23	F/C	40,0	20,0	42,0	24,0	86,3	6	9,3	6
COPA-S-29B	COPA-S-29G	29	F/C	46,5	20,0	48,0	27,0	99,3	6	11,1	6
COPA-S-36B	COPA-S-36G	36	F/C	55,0	20,0	56,0	31,0	116,3	6	14,4	4
COPA-S-48B	COPA-S-48G	48	F/C	67,0	20,0	68,0	37,0	140,3	6	19,9	4

关于产品库存, 交期, 尺寸及颜色等问题请联系我们本地的经销商或客服。

Please contact our local distribution partner or our customer service regarding product availability, lead time, other sizes and colours.

产品代码 / Number code:

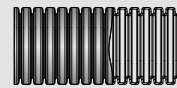
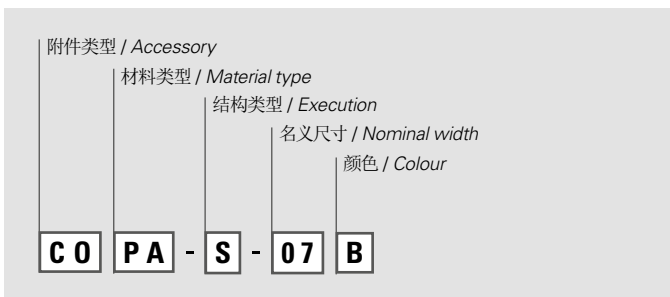

细波型 F / Fine profile F

更小的弯曲半径 / Tight bending radius



粗波型 C / Coarse profile C

更高的拔脱强度 / High pull-out strength

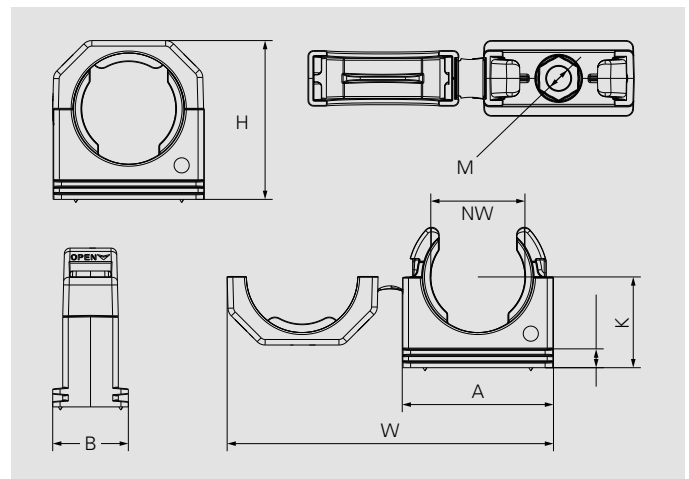

我们尽我们的知识水平所提供的数据, 图像和技术规格图反映了当前的工程技术水平。这并不包含对最后应用有关的任何责任。产品用户需根据应用进行自己的评估, 以确定产品是否符合特殊的应用条件。我们对产品的责任只考虑一般规定条件下的水平。FIP保留对产品数据和数值进行技术调整的权利。例如更改材料和加工工艺, 在保证产品性能数值不下降的情况下不会另行通知。

The provided data, images and technical specification drawings reflect the current engineering level and are to the best of our knowledge. This does not include any liability regarding the final application. Users of the products have to make their own evaluation to determine the suitability for a specific application. Our liability for these products considers the stated level within our General Conditions only. FRAENKISCHE Industrial Pipes (FIP) reserves the right to adjust specified data and values as well as implementing technical adjustments of the products e. g. change of materials and processing technologies without prior notice as long as the specified values are not reduced.

固定座安装说明

Assembly instruction mounting clip

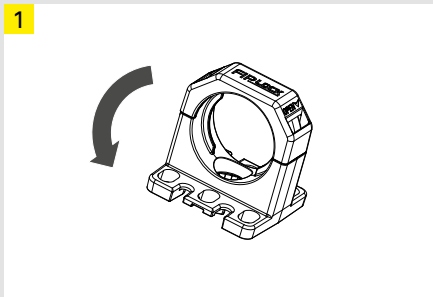

打开固定座上盖。
Open cover of mounting clip.

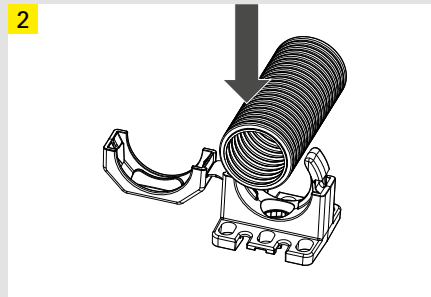

将波纹管要固定的位置卡入固定座，直至完全被包裹(Pic 3)。
Apply corrugated conduit at foreseen position onto the clip and push in until the corrugated conduit is properly surrounded (Pic 3).

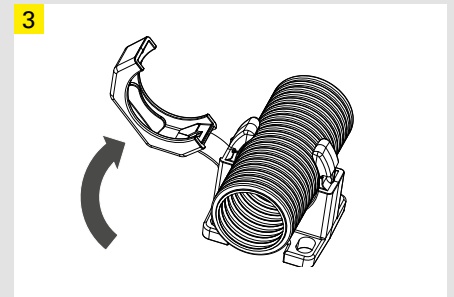

合上上盖，锁住。
Close cover of mounting clip – „click“ to lock.

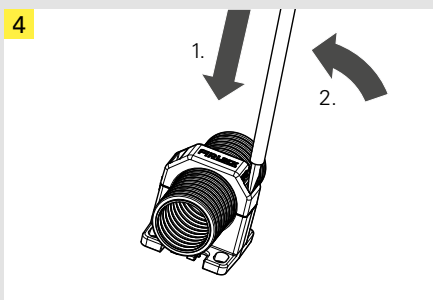

如果要打开固定座上盖，使用一个起子，插入上盖的有标记“OPEN”的槽中，然后轻微弯曲，打开倒扣，即可将波纹管取出。

To re-open cover of mounting clip, use a commercial screw driver. Apply it to the slot marked „OPEN“ and slightly bend it to re-release cover lock. Pull-off corrugated conduit.