

BRPA

多孔波纹管固定座

Multiple conduit mounting rail

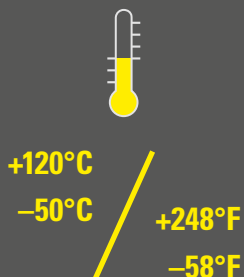

	min.					max.
温度范围 Temperature range						
UV保护性能 UV protection						
低温性能 Cold environment performance						
继续强度 Mechanical strength						

其他类型:
More versions:

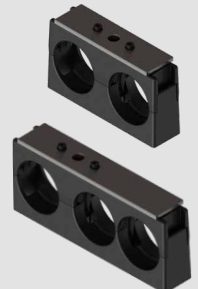

材料: PA6 MOD V0 SGA

FIPLOCK® 多孔波纹管固定座BRPA由改性无卤的PA6制成, 产品节省了安装空间, 且可堆叠使用。安装时仅需一根螺杆, 将底座穿入螺杆进行预安装, 固定座也可用额外的螺母或螺丝头限位, 波纹管卡入安装穴中, 然后上盖用倒扣锁定。为保证安装稳固, BRPA固定座最后需要在顶部安装一个不锈钢加强板。这款多孔固定座同时有 2, 3 及4孔多款不同版本。

Material: PA6 MOD V0 SGA

The FIPLOCK® multiple conduit mounting rail BRPA is a space-saving, stackable corrugated conduit mounting support made of specially modified, halogen-free PA6. For installation only one mounting screw or a threaded rod is required and allows pre-locking when the system support base is pushed onto the rod. The base can then be additionally secured with a locknut and the conduits can be applied into the cavities accordingly. The system support cover is simply snapped onto the mounted system support base and securely closed. For stability purpose the BRPA system support is finally fixed with a stainless steel rail. The multiple conduit mounting rail is available in versions with 2, 3 or 4 conduit ducts for conduits available rotatable and axial fixed.

BRPA

产品性能 / Product performances

应用性能 / Application performances	特性 Characteristics	单位 Unit	标准规范 Standards, specifications	备注 Remark
温度范围 Temperature range	-50 到 / to +120 -58 到 / to +248	°C °F	IS FIP	
温度 (短周期) Temperatur (short-term)	150 (500 h); 165 (100 h) 302 (500 h); 329 (100 h)	°C °F	IS FIP	
防火性能 / Fire safety performances				
不含卤素和镉 Free from halogens and cadmium	是 / yes			
阻燃等级 Fire classification	V0		UL 94	
产品防火特性 Fire characteristic of the product	自熄 self-extinguishing		UL 1696	
氧指数 Oxygen index	>32	%	EN ISO 4589-2	
灼热丝测试 Glow wire test	960 1760	°C °F	IEC 60695	
火灾危害等级 Fire hazardous level	HL3 R22 HL3 R23		EN45545-2	
火焰蔓延 Spread of fire	非火焰蔓延 non flame propagating		IEC EN 61386	
耐候性 / Weathering performances				
UV及耐候性 UV and weathering performance	优异 excellent		IS FIP	可达40年 up to 40 years

测试条件参照EN ISO 139温度23°C, 湿度 / 50% (如未注明测试条件)。IS FIP = FIP内部测试规范。
Tests carried out acc. EN ISO 139 at 23°C / 50% r. h. (if not indicated different). IS FIP = Internal Specification FIP

产品号 Part No.	名义尺寸 Nominal width	尺寸 mm Dimensions in mm						重量 Weight	单位 PU
黑色 / black	NW	A	B	D	E	F	G	g	个 / Pcs
BRPA-36B-2	36	117,5	64,0	60,0				177,4	4
BRPA-48B-2	48	142,6	76,0	73,0				226,0	4
BRPA-36B-3	36	164,0	64,0	60,0		46,5	58,8	252,7	4
BRPA-48B-3	48	201,6	76,0	73,0		59,0	71,3	323,5	4
BRPA-36B-4	36	210,5	64,0	60,0	153,0			327,9	4
BRPA-48B-4	48	260,6	76,0	73,0	191,0			420,9	4

关于产品库存, 交期, 尺寸及颜色等问题请联系我们本地的经销商或客服。

Please contact our local distribution partner or our customer service regarding product availability, lead time, other sizes and colours.

产品代码 / Number code:

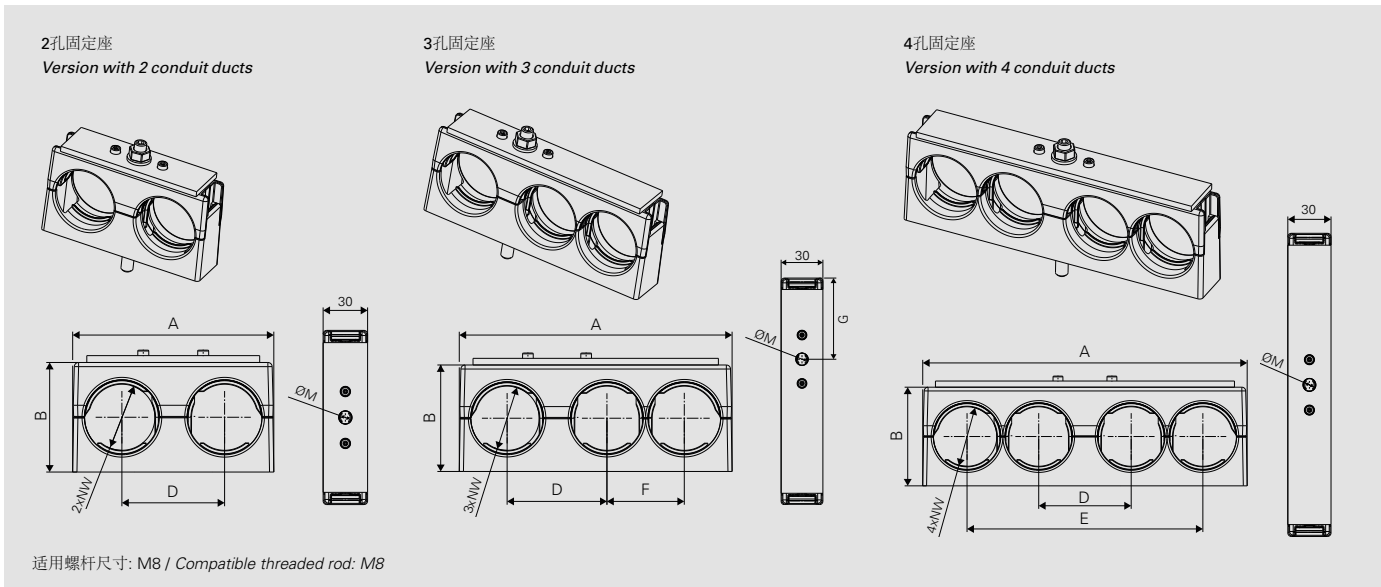
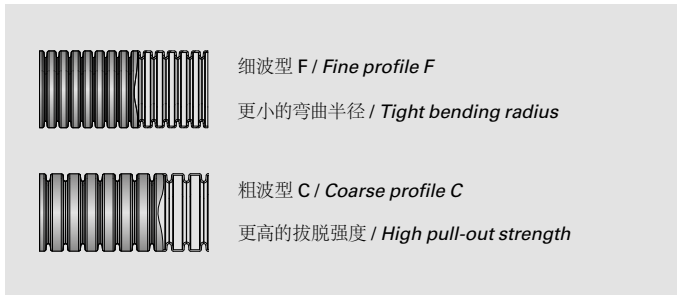
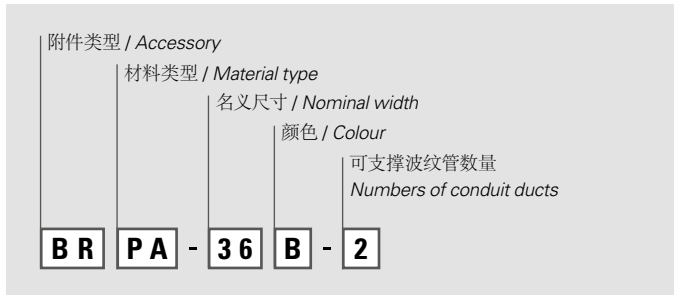

我们尽我们的知识水平所提供的数据, 图像和技术规格图反映了当前的工程技术水平。这并不包含对最后应用有关的任何责任。产品用户需根据应用进行自己的评估, 以确定产品是否符合特殊的应用条件。我们对产品的责任只考虑一般规定条件下的水平。FIP保留对产品数据和数值进行技术调整的权力。例如更改材料和加工工艺, 在保证产品性能数值不下降的情况下不会另行通知。

The provided data, images and technical specification drawings reflect the current engineering level and are to the best of our knowledge. This does not include any liability regarding the final application. Users of the products have to make their own evaluation to determine the suitability for a specific application. Our liability for these products considers the stated level within our General Conditions only. FRAENKISCHE Industrial Pipes (FIP) reserves the right to adjust specified data and values as well as implementing technical adjustments of the products e. g. change of materials and processing technologies without prior notice as long as the specified values are not reduced.

多孔波纹管固定座安装说明

Assembly instruction multiple conduit mounting support

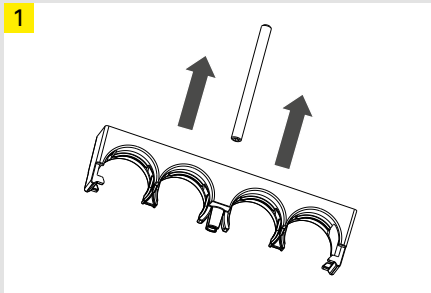

将底座推进螺杆（螺杆不包含在包装里）。底座中间孔中带了一个锁闭功能，防止底座掉落。
使用标准螺丝安装，转入第三步。

*Push support base on threaded rod (not included). Latching function for pre-mounting. (Example: over head)
To install with standard screw, start with pic 3.*

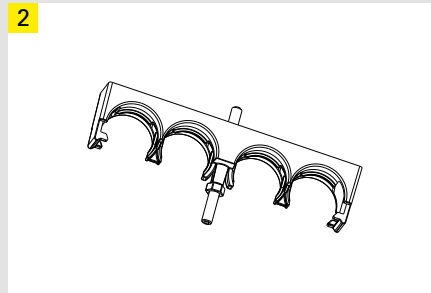

可选项: 使用一个六角螺母（螺母不包含在包装里）锁在螺杆上确保底座固定。

Optional: Screw a hexagon nut (not included) onto the threaded rod to secure the support base.

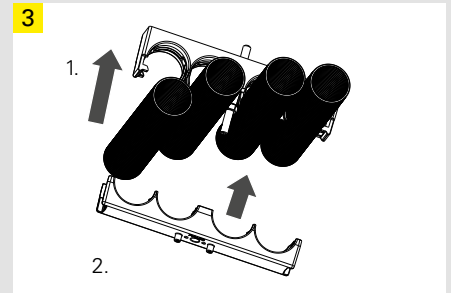

将波纹管装入固定座孔穴(1)中，然后将上盖(2)装入底座直到听到咔哒一声。

Apply corrugated conduits into the cavities (1) and push the support cover (2) onto the base until the "click".

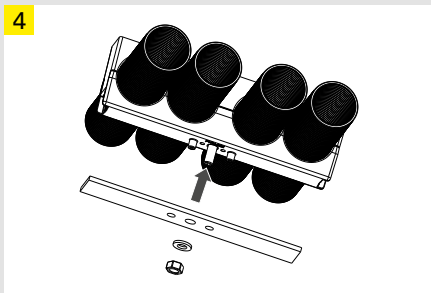

将不锈钢板穿进螺杆装入固定座上盖上。
Push stainless steel stabilizer-plate over the threaded rod onto the support cover.

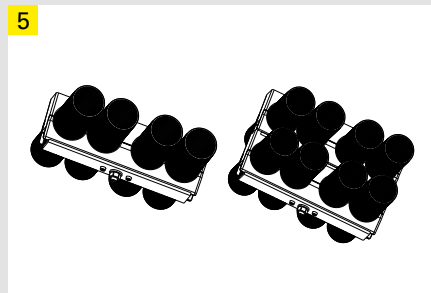

装入垫片，螺母拧入螺杆锁紧不锈钢板。或使用标准螺丝将装配好的固定座安装到箱体板面上。
如果需要将固定座堆叠使用，就需要一根更长的螺杆或标准螺丝。在这种情况下按照第一步的步骤开始安装。

*Tightly secure stabilizer-plate with washer and Locknut on threaded rod. Or apply standard screw to tight assembled support to the pannel.
For stacking application a longer threaded rod or a longer standard screw is required. In this case start procedure form beginning.*

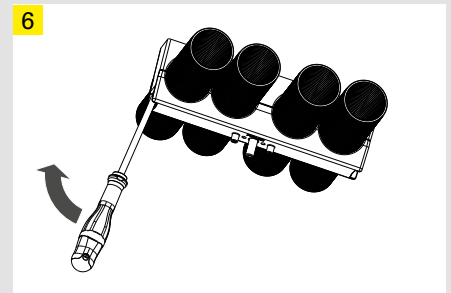

拆卸时，先松掉螺母取出不锈钢板。
打开固定座上盖时，使用一个起子插入两侧的倒扣内，向外轻轻扳动，即可打开上盖。

*To dismantel, release stabilizer plate nut and remove stabilizer plate.
To open support cover, use a commercial screw driver. Apply it behind the snap-fit at the side and slightly bend it to release cover lock. Pull-off corrugated conduits from support base.*